

INDUSTRIAL CONICAL MOUNT SERIES: 26749 & 27595

Dimensions & Performance Characteristics

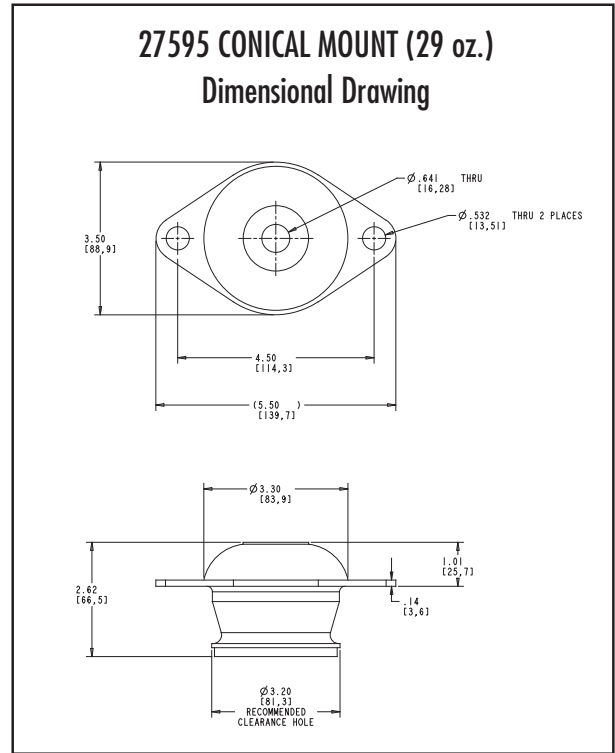
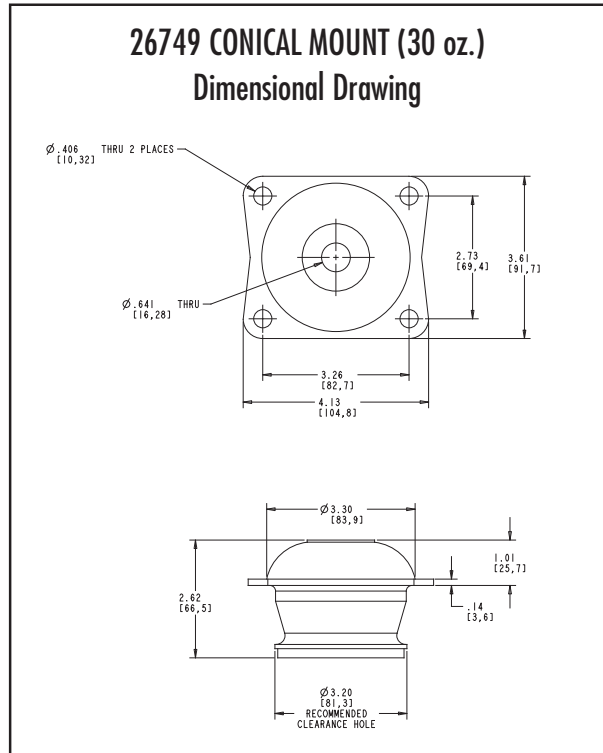

| Part Number | Max. Axial Load Range (lbs.) | Color Code | Natural Frequency at Max. Load | Radial to Axial Stiffness Ratio | Bolt Size | Bolt Grade | | Torque | |
|-------------|------------------------------|------------|--------------------------------|---------------------------------|-------------|------------|-----|--------|-----|
| | | | | | | SAE | ISO | ft-lbs | N-m |
| 26749-45 | 463 lbs. | White | 12 Hertz | 1.5:1 | 5/8" or M16 | 5 | 8.8 | 180 | 235 |
| 26749-60 | 860 lbs. | Brown | 12 Hertz | 1.5:1 | 5/8" or M16 | 5 | 8.8 | 180 | 235 |
| 26749-70 | 1,146 lbs. | Orange | 12 Hertz | 1.5:1 | 5/8" or M16 | 5 | 8.8 | 180 | 235 |
| 27595-45 | 463 lbs. | White | 12 Hertz | 1.5:1 | 5/8" or M16 | 5 | 8.8 | 180 | 235 |
| 27595-60 | 860 lbs. | Brown | 12 Hertz | 1.5:1 | 5/8" or M16 | 5 | 8.8 | 180 | 235 |
| 27595-70 | 1,146 lbs. | Orange | 12 Hertz | 1.5:1 | 5/8" or M16 | 5 | 8.8 | 180 | 235 |