

INDUSTRIAL MACHINERY MOUNT SERIES

Low-frequency elastomeric compression mounts for industrial machinery.

APPLICATIONS

- Heavy industrial equipment, machinery and tools
- Motors, pumps and generators

FEATURES

- Ideal for heavy industrial machinery
- For all types of industrial machinery
- Cold-rolled steel construction
- Provides efficient isolation for speeds as low as 750 rpm
- Compressive to shear stiffness of 5:1

BENEFITS

- Protects industrial equipment from damage caused by extended shock, noise and vibration exposure
- Extends machinery life
- Wide load range available
- Low maintenance
- Resistant to oils, most solvents and ozone

LOAD RANGE

- 670 Series = 3 ratings to 1,500 lbs. per mount
- 297 Series = 4 ratings to 4,400 lbs. per mount

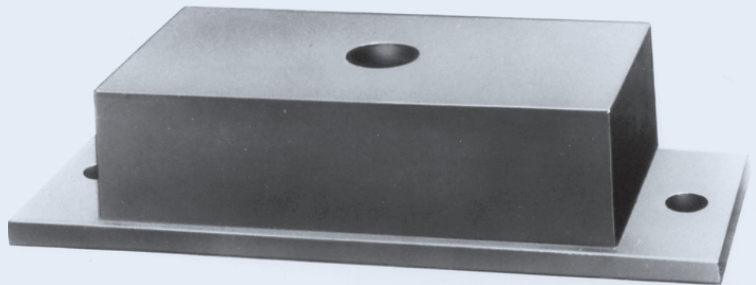

Barry Industrial Machinery Mounts are for use under heavy industrial machinery for shock, vibration and/or structure borne noise control. Barry Machinery Mounts provide efficient isolation for machine speeds as low as 750 rpm.

Specifications

• Natural Frequency	8-18 Hertz
• Transmissibility at resonance	8:1
• Resilient Element	Neoprene
• Standard Materials	Cold rolled steel
• Weight	Series 661 = 2 lbs. Series 670 = 2 lbs. Series 297 = 3 lbs.

Environmental Data

- Neoprene elastomer has an operating temperature range of -20°F to +180°F (-30°C to +82°C) and is resistant to oils, most solvents and ozone.

MACHINERY MOUNT SERIES: 661 SERIES

Dimensions & Performance Characteristics

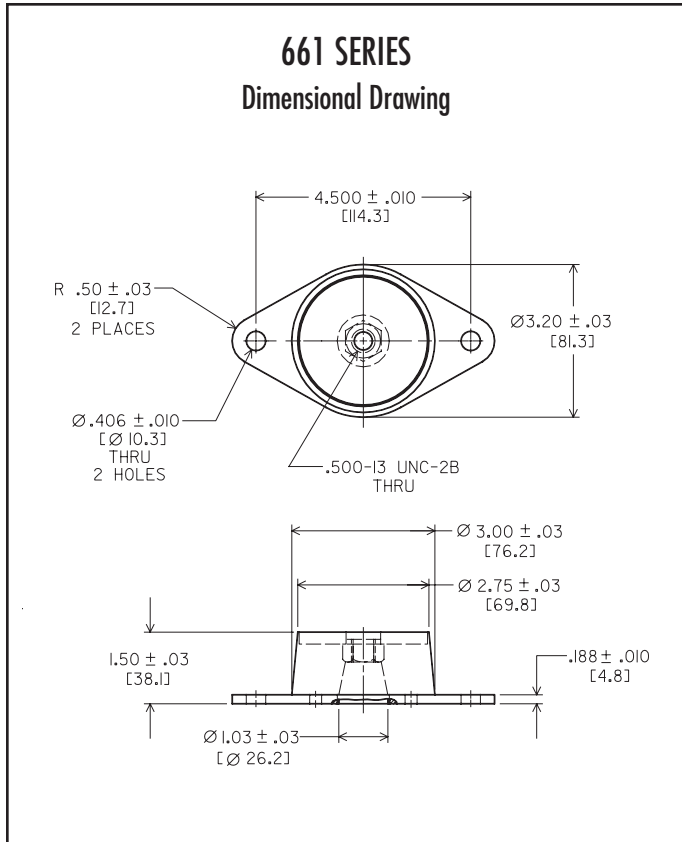

661 SERIES LOAD RANGE DATA	
Part #	Maximum Static Load/Isolator (lbs.)
661-30	300
661-45	450
661-55	550
661-70	700

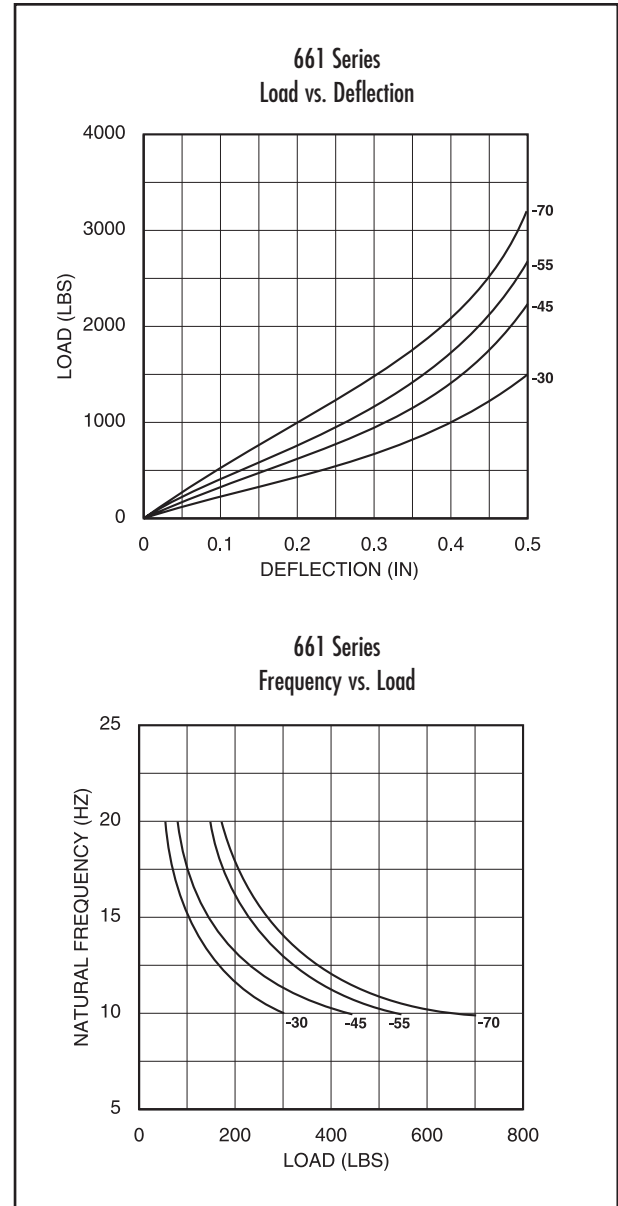

MACHINERY MOUNT SERIES: 661 SERIES

Dimensions & Performance Characteristics

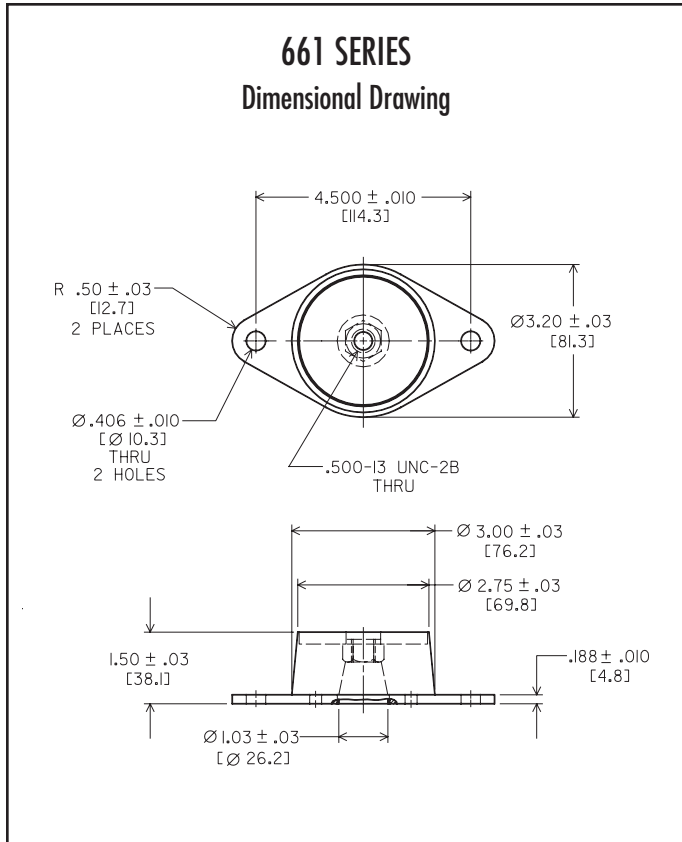

661 SERIES LOAD RANGE DATA	
Part #	Maximum Static Load/Isolator (lbs.)
661-30	300
661-45	450
661-55	550
661-70	700

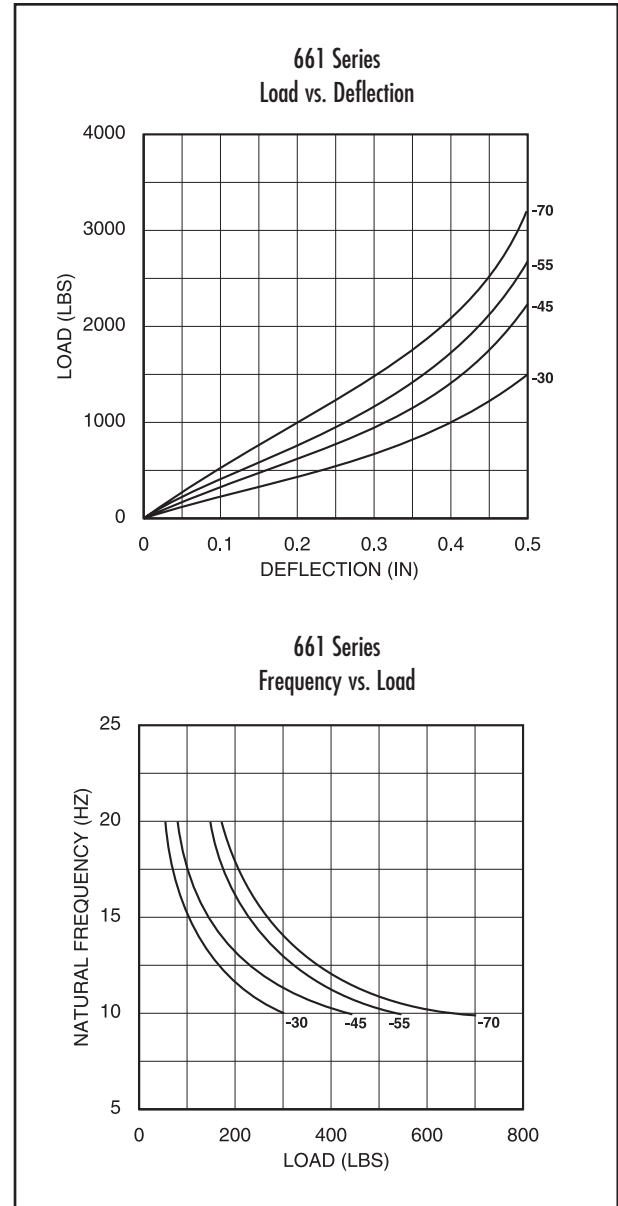

MACHINERY MOUNT SERIES: 670 SERIES

Dimensions & Performance Characteristics

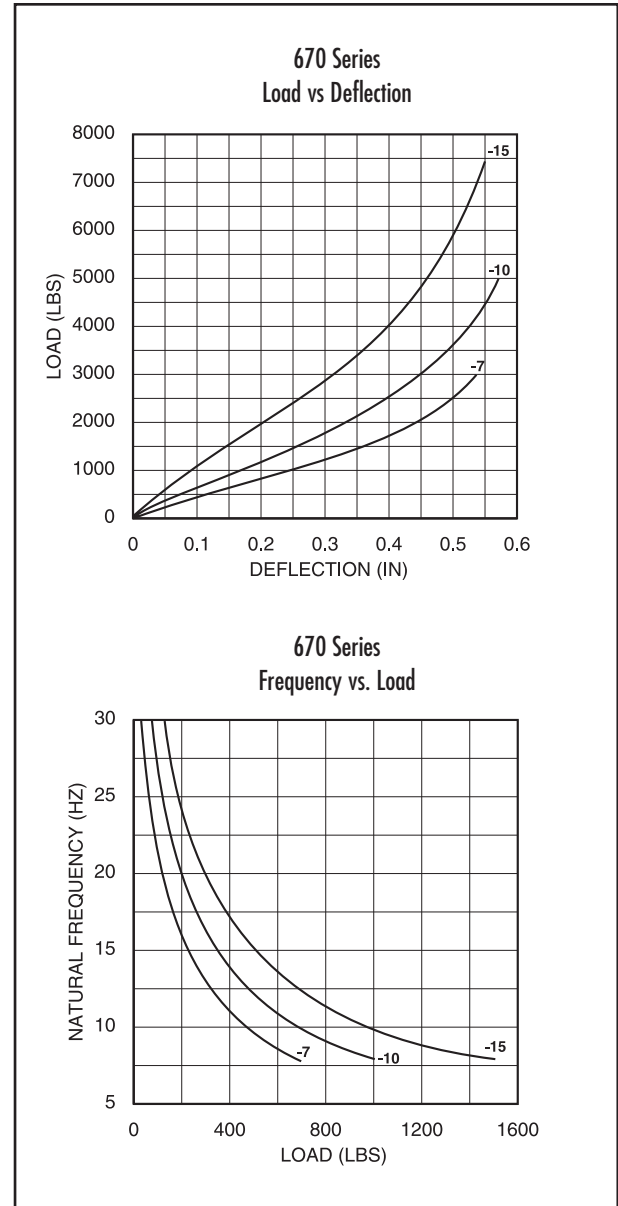
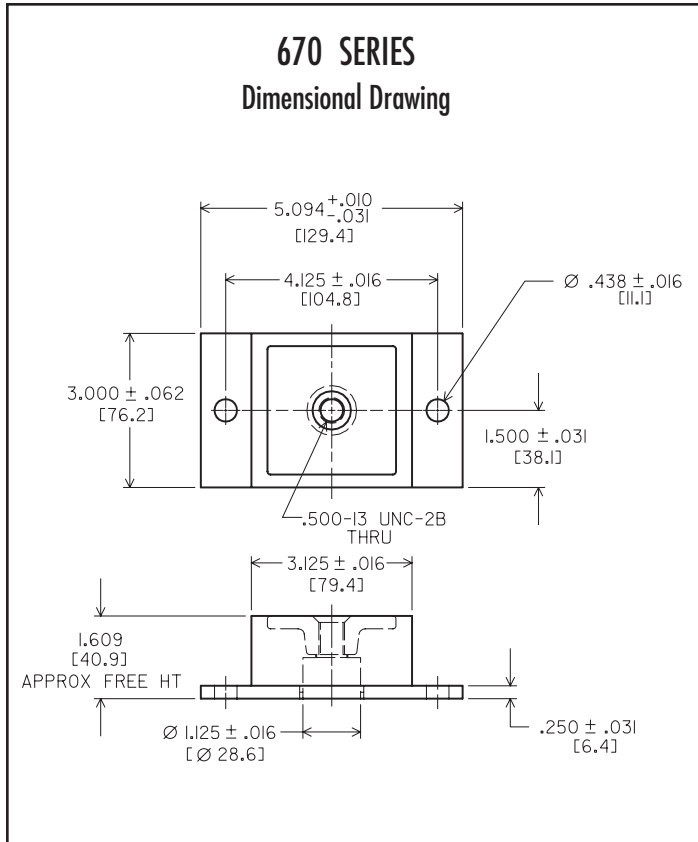

670 SERIES LOAD RANGE DATA	
Part #	Maximum Static Load/Isolator (lbs.)
670-7	700
670-10	1,000
670-15	1,500

MACHINERY MOUNT SERIES: 670 SERIES

Dimensions & Performance Characteristics

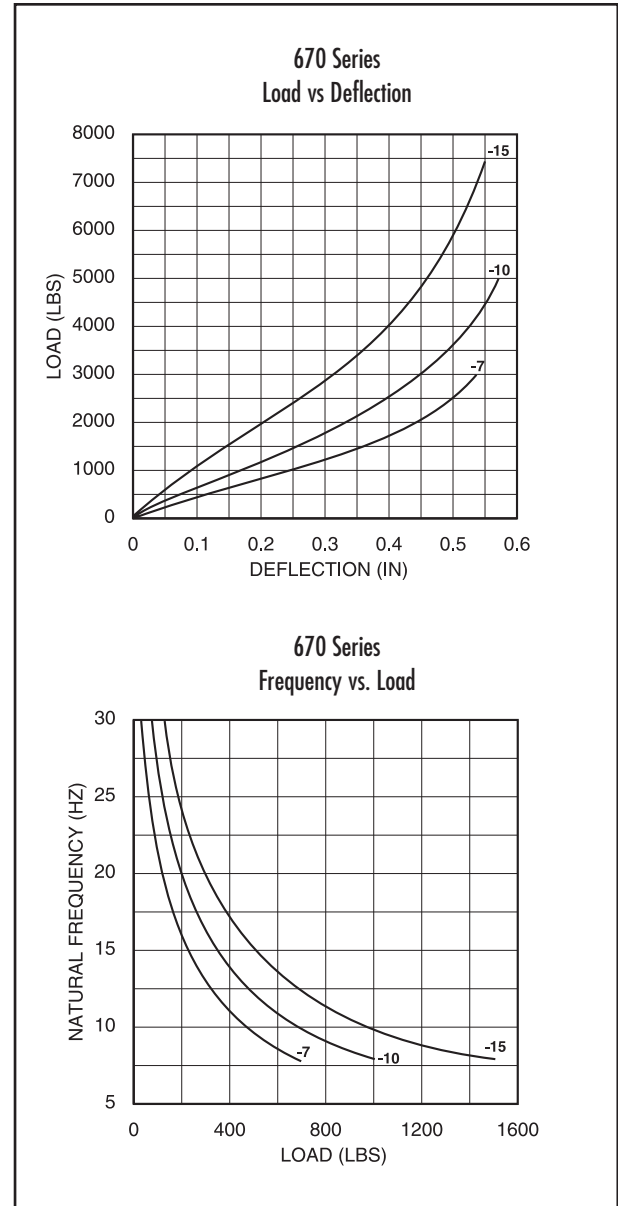
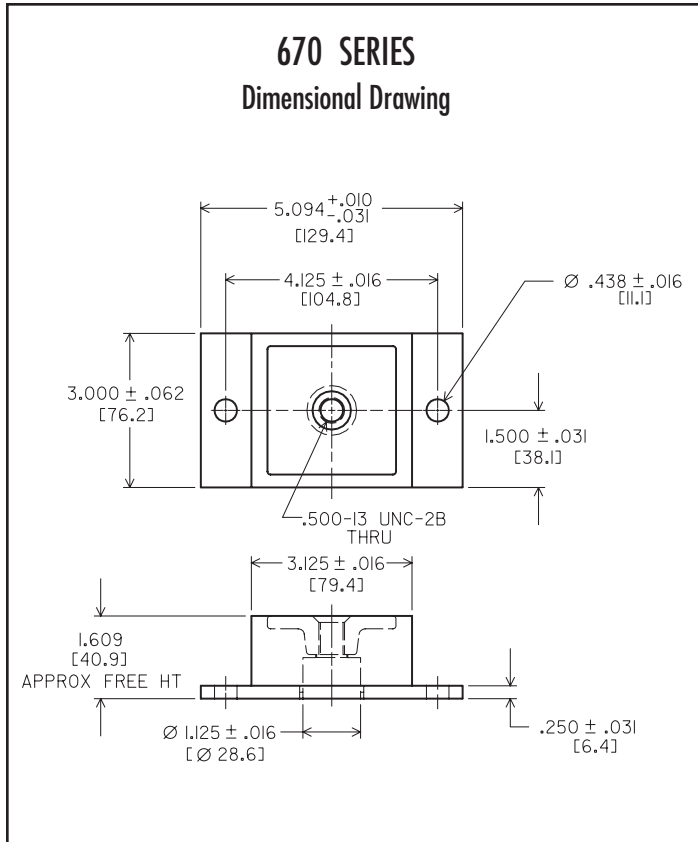

670 SERIES LOAD RANGE DATA	
Part #	Maximum Static Load/Isolator (lbs.)
670-7	700
670-10	1,000
670-15	1,500

MACHINERY MOUNT SERIES: 297 SERIES

Dimensions & Performance Characteristics

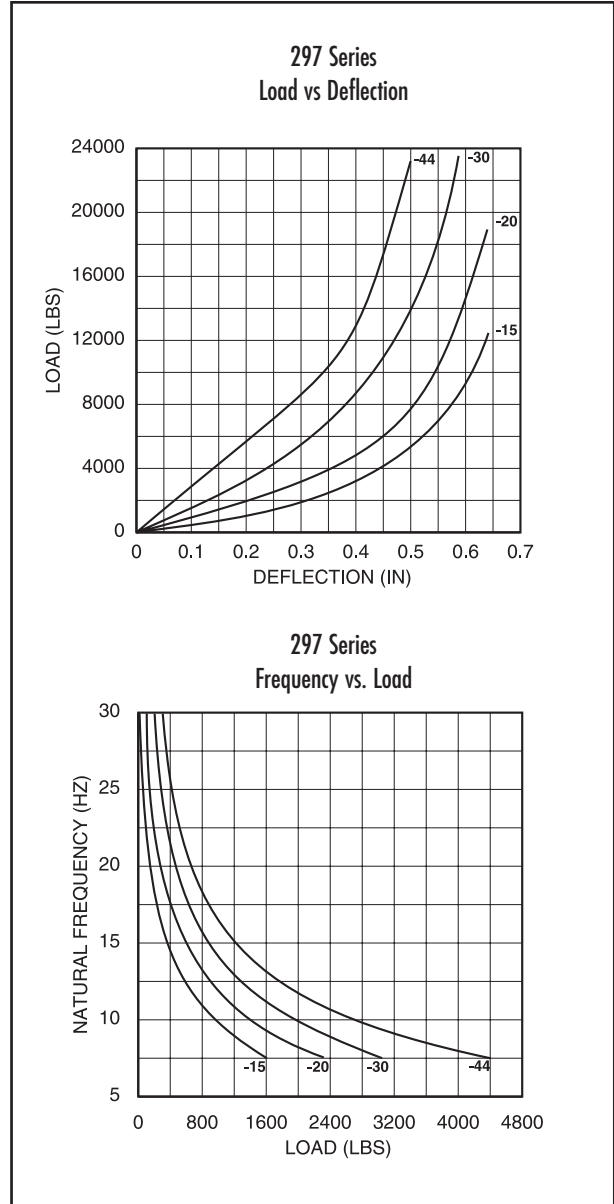
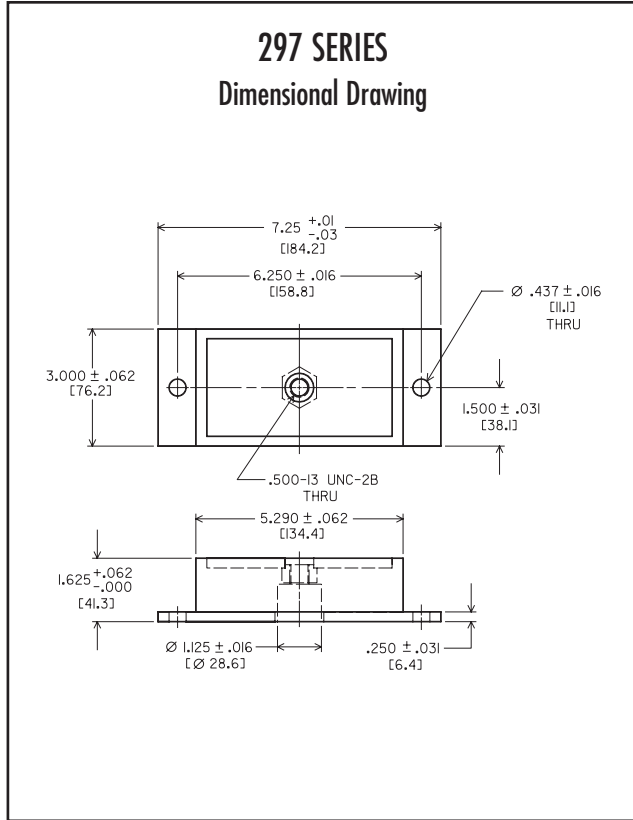

297 SERIES LOAD RANGE DATA	
Part #	Maximum Static Load/Isolator (lbs.)
297-15	1,500
297-20	2,000
297-30	3,000
297-44	4,400