

LEVELING MOUNTS

Low-profile, high capacity leveling mounts for vibration and shock protection.

APPLICATIONS

- Punch Presses
- Milling Machines
- Drilling Machines
- Boring Machines
- Die casting machines
- Screw machines
- Injection Molding
- Lathes
- Grinders
- Jig Borers
- Riveters
- Sanders
- Saws
- Shapers

FEATURES

- High level of shock & vibration isolation
- Full inch of elastomer for controlled deflection
- Leveling bolt adjusts height up to a full half inch above load
- Sturdy, reliable construction

BENEFITS

- Economical
- Extends machinery life
- Wide load range available

LOAD RANGE

- 7 sizes with load ratings to 13,000 lbs. per isolator



Barry Leveling Mounts are ideal for protecting heavy industrial equipment and machinery such as CNC machines, punch presses, drill presses, sanders, saws, injection molding and many other types of industrial equipment.

Specifications

• Natural Frequency	12-18 Hertz
• Transmissibility at resonance	8:1
• Resilient Element	LM0-B + LM1-B Neoprene LM3-B through LM9-B Nitrile
• Weight	See load range chart

Environmental Data

- Nitrile and Neoprene elastomers have an operating temperature range of -20°F to +180°F (-30°C to +82°C) and are resistant to oils and most solvents.

LEVELING MOUNTS:

Dimensions & Performance Characteristics

LEVELING MOUNT SERIES LOAD RATING & DIMENSIONAL DATA						
Part #	Load Range Rating (lbs.)	Base (Inches)		Bolt (Inches)		Weight
		Outside Dia. (A)	Free Height (B)	Size	Length	
LM0-B	30-100	2	1	.25-28	1.75	4 ozs.
LM1-B	100-300	3.125	1.50	.375-24	3	1 lb. 4 ozs.
LM3-B	300-1,000	4.75	1.50	.50-13	5	2 lbs. 5 ozs.
LM5-B	1,000-4,200	6.312	1.625	.75-10	5	5 lbs. 2 ozs.
LM6-B	4,000-10,000	7.25	1.61	.75-10	5	7 lbs. 6 ozs.
LM7-B	4,000-13,000	9	2.50	1-14	8	12 lbs. 14 ozs.
LM9-B*	4,000-13,000	9	2.25	1-14	8	12 lbs. 11 ozs.

* LM-9B should be substituted for LM-7B in applications with heavy horizontal forces.
 For punch press applications between 150-300 SPM, reduce load rating of each mount by 50%. Above 300 SPM, please call Barry Controls applications engineering at 1-800-BARRY-MA.

METRIC LEVELING MOUNT SERIES LOAD RATING & DIMENSIONAL DATA						
Part #	Load Range Rating (lbs.)	Base (Inches)		Bolt (Inches)		Weight
		Outside Dia. (A)	Free Height (B)	Size	Length	
LM0-MB	30-100	2	1	M6-1	30 mm	4 ozs.
LM1-MB	100-300	3.125	1.50	M10-1.5	75 mm	1 lb. 4 ozs.
LM3-MB	300-1,000	4.75	1.50	M12-1.75	127 mm	2 lbs. 5 ozs.
LM5-MB	1,000-4,200	6.312	1.625	M20-2.5	127 mm	5 lbs. 2 ozs.
LM6-MB	4,000-10,000	7.25	1.61	M20-2.5	127 mm	7 lbs. 6 ozs.
LM7-MB	4,000-13,000	9	2.50	M24-3	200 mm	12 lbs. 14 ozs.
LM9-MB*	4,000-13,000	9	2.25	M24-3	200 mm	12 lbs. 11 ozs.

* LM-9B should be substituted for LM-7B in applications with heavy horizontal forces.
 For punch press applications between 150-300 SPM, reduce load rating of each mount by 50%. Above 300 SPM, please call Barry Controls applications engineering at 1-800-BARRY-MA.

OPTIONAL BOLTS & BUSHINGS FOR LEVELING MOUNTS:

Ordering Information

OPTIONAL BOLTS WITH NUTS		
Part#	Comes Standard w/:	Size (in.)
2099-02000/1	LM3-B	3/8-16x5
100551-01000/1		1/2-13x5
2099-12000/1		1/2-13x8
2099-16000/1		1/2-13x10
2099-07000/1		5/8-11x5
2099-10000/1	LM5-B/LM6-B	5/8-11x8
100551-03000/1		3/4-10x5
2099-11000/1		3/4-10x8
2099-09000/1		3/4-10x10
100551-19000/1		1-14x5
100551-16000/1	LM7-B/LM9-B	1-14x8
2099-29000/1	LM0-B	1/4-28x1-3/4
2099-30000/1	LM1-B	3/8-24x3

OPTIONAL BUSHINGS FOR MOUNTS:		
Part#	Designed for Mount:	Size (in.)
101056-01801	LM5-B/LM6-B	3/4-10 to 3/8-16
101056-02801	LM5-B/LM6-B	3/4-10 to 1/2-13
101965-03801	LM7-B/LM-9B	1-14 to 1/2-13
101965-02801	LM7-B/LM-9B	1-14 to 5/8-11
108123-03801	LM7-B/LM-9B	1-14 to 3/4-10

METRIC BOLTS & BUSHINGS FOR LEVELING MOUNTS:

Ordering Information

METRIC BOLTS w/NUTS		
Part#	Designed for Mount:	Size (in.)
2099-39000/1	LM0-MB	M6-1 x 1.181 (30 mm)
2099-40000/1	LM1-MB	M10-1.5 x 2.953 (75 mm)
2099-44000/1	LM3-MB	M12-1.75 x 5 (127 mm)
2099-43000/1	LM5-MB/LM6-MB	M20-2.5 x 5 (127 mm)
2099-41000/1	LM7-MB/LM9-MB	M24-3.0 x 7.874 (200 mm)

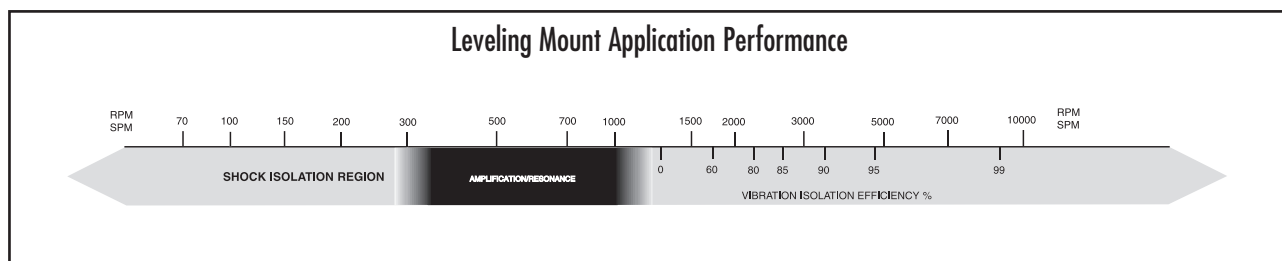
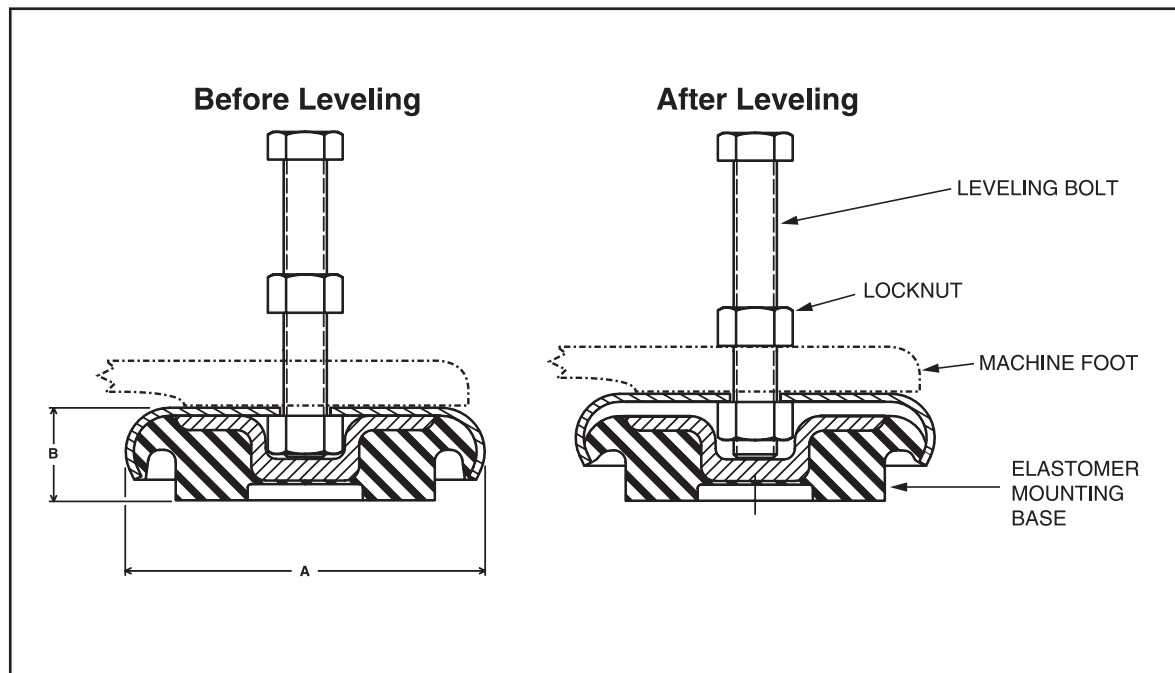

LMS MOUNT SERIES

Attenuated levelers designed for leveling and aligning sensitive electronic manufacturing equipment

APPLICATIONS

- Semiconductor equipment
- Electronic manufacturing equipment
- Industrial machinery

FEATURES

- Neoprene elastomer bonded to steel construction
- Corrosion resistant exposed metal parts
- Proven durability
- ANSI and metric steel threads

BENEFITS

- Non skid elastomer
- Protects floor or surface finish
- Extends machinery life
- 1/2" of elastomer for controlled deflection and attenuation



LMS attenuated levelers are designed for leveling, aligning and isolating sensitive electronic manufacturing equipment. LMS Series levelers feature over .5" of neoprene elastomer bonded to the bottom of the leveler to provide shock-attenuated, non-skid support.

Specifications

• Natural Frequency	10-20 Hertz
• Transmissibility at resonance	8:1
• Resilient Element	Neoprene
• Standard Materials	Black Corrosion Resistant Steel
• Elastomer Color	Black

Environmental Data

- Neoprene elastomer has an operating temperature range of -20°F to +180°F (-30°C to +82°C) and is resistant to oils, most solvents and ozone.

LMS MOUNT SERIES:

Dimensions & Performance Characteristics

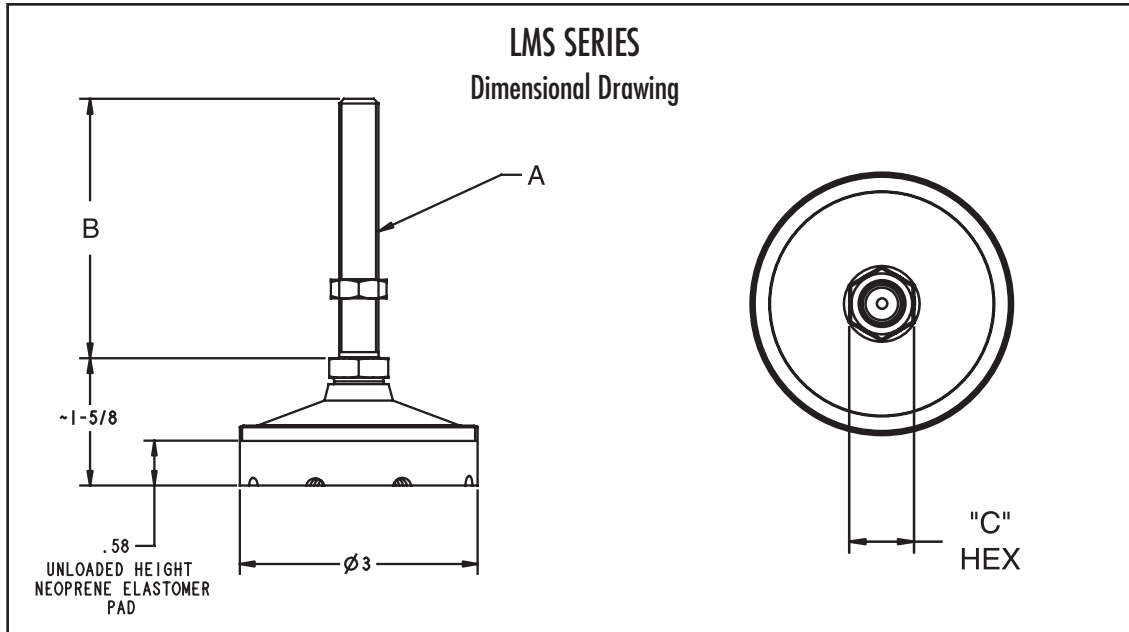

LMS MOUNT SERIES LOAD RATING & DIMENSIONAL DATA					
Part #	Load Range Rating (lbs.)	Thread Units	"A"	"B"	"C"
LMS-12042	100-400	INCH	.500-13 UNC 2B	2"	.750"
LMS-12044	100-400			4"	
LMS-12082	200-800			2"	
LMS-12084	200-800			4"	
LMS-12122	400-1200			2"	
LMS-12124	400-1200			4"	
LMS-M112042	100-400	METRIC	M12 x 1.75	51 mm	19 mm
LMS-M112043	100-400			84 mm	
LMS-M112082	200-800			51 mm	
LMS-M112083	200-800			84 mm	
LMS-M112122	400-1200			51 mm	
LMS-M112123	400-1200			84 mm	