

V MOUNT SERIES

Engine mounts isolate vibration, absorb shock and attenuate noise due to structure-borne vibrations.

APPLICATIONS

- Class 6,7,8 truck engines
- Bus engines
- Off-highway vehicle engines
- On & off-highway vehicle cabs

FEATURES

- Low natural frequency (9-10 Hertz)
- Long, dependable service life
- Off-the-shelf availability
- Proven durability

BENEFITS

- Improved ride comfort
- Prevents mechanical noise transmission
- Ensures drivetrain alignment
- Eliminates minor shake
- Superior V-mount isolation

LOAD RANGE

- 3 load ratings from 950 - 1400 lbs. per mount

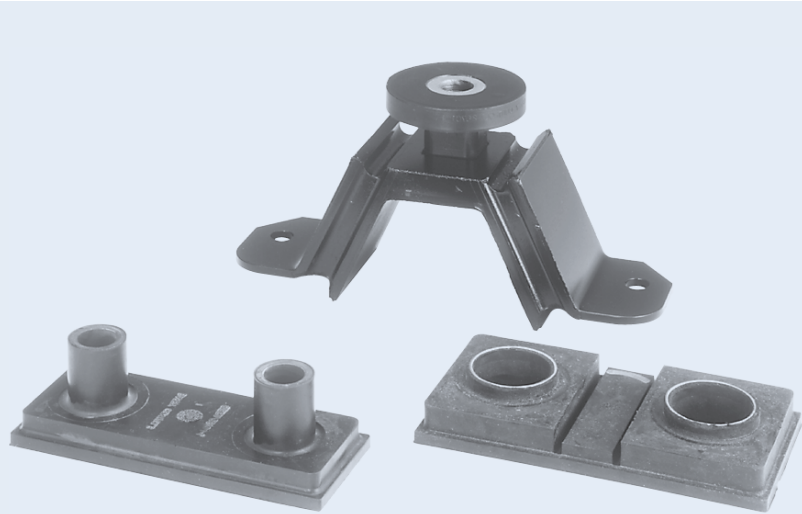

Barry V-Spring Engine mounts isolate vibration, absorb shock and attenuate noise due to structure-borne vibration. These mounts feature uniquely tuned stiffnesses to achieve optimum performance and ride comfort.

Specifications

• Natural Frequency	9-10 Hertz
• Transmissibility at resonance	8:1
• Resilient Element	Natural Rubber (Neoprene Optional)
• Standard Materials	High Strength Steel
• Weight	4.3 lbs. (w/snubber)

Environmental Data

- Natural rubber elastomer has an operating temperature range of -40°F to +180°F (-40°C to +82°C).
- Neoprene elastomer has an operating temperature range of -20°F to +180°F (-30°C to +82°C).

V MOUNT SERIES:

Dimensions & Performance Characteristics

LOAD & STIFFNESS CHARACTERISTICS										
Part #	Load Range		Vertical Deflection		Nominal Static Characteristics					
	lbs.	N	in.	mm	Vertical		Lateral		Longitudinal	
					lbs./inch	N/mm	lbs./inch	N/mm	lbs./inch	N/mm
27330-1	1,150-1,400	5,110-6,220	.10"	2.5	13,000	2,280	6,500	1,140	19,500	342
27330-2	950-1,200	4,220-5,330	.11"	2.9	9,400	1,650	4,700	825	14,000	2,457

